

AWD OPEN TYPE 3.2/4.0/4.8



AWD3.2-4.8FCHE

For installation information please refer to the tooling overview and manuals on our website www.scell-it.com
 Pour les conditions de pose, merci de vous référer à la description de l'outil et aux manuels disponibles sur notre site web.
 Angaben zur Verarbeitung entnehmen Sie bitte der Geräteübersicht und den Betriebsanleitungen auf unserer Website.
 Pro informace ohledně montáže navštivte naše webové stránky nebo nahlédněte do manuálu k nářadí.

| ENGLISH | FRANÇAIS | DEUTSCH | CZECH |
|------------------|-------------------------|---------------------|-------------------|
| Mandrel : Steel | Tige : Acier | Dorn : Stahl | trn : Ocel |
| Body : Aluminium | Corps : Aluminium | Körper : Aluminium | dfik : Hliník |
| Dome head white | Tête plate laquée blanc | Flachrundkopf weiss | plochá hlava bílá |

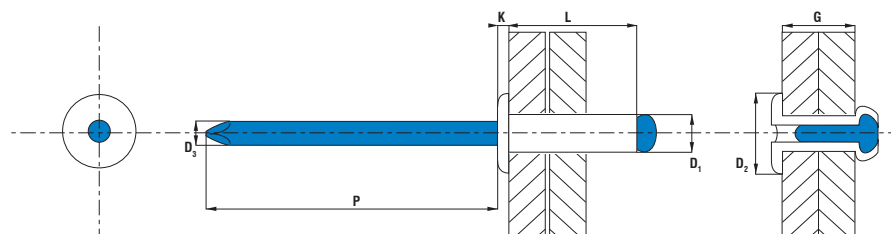

| PART NO/REF | D ₁ | L | D ₂ | K | D ₃ | P | G |
|-------------|----------------------|-----------------|--------------------|--------------------|----------------|-----------|--------------|
| | Ø (mm) | (mm)+1.0 / -0.2 | Ø (mm) | (mm) | Ø (mm) | mini (mm) | min-max (mm) |
| AWD3206 | 3.2 +0.08 / -0.10 | 6.0 | 6.5 -0.7 / +0.0 | 0.8 -0.2 / +0.2 | 1.25 | 27 | 1.5-3.5 |
| AWD3208 | | 8.0 | | | | | 3.5-5.0 |
| AWD3210 | | 10.0 | | | | | 5.0-7.0 |
| AWD3212 | | 12.0 | | | | | 7.0-9.0 |
| AWD4008 | 4.0 +0.08 / -0.15 | 8.0 | 8.0 -1.0 / +0.0 | 1.0 -0.3 / +0.3 | 2.18 | 27 | 4.0-5.0 |
| AWD4010 | | 10.0 | | | | | 5.0-6.5 |
| AWD4012 | | 12.0 | | | | | 6.5-8.5 |
| AWD4016 | | 16.0 | | | | | 10.5-12.5 |
| AWD4018 | | 18.0 | | | | | 12.5-14.5 |
| AWD4020 | 20.0 | 14.5-16.5 | | | | | |
| AWD4810 | 4.8 +0.08 / -0.15 | 10.0 | 9.5 -1.0 / +0.0 | 1.1 -0.3 / +0.3 | 2.70 | 27 | 4.5-6.0 |
| AWD4812 | | 12.0 | | | | | 6.0-8.0 |
| AWD4816 | | 16.0 | | | | | 10.0-12.0 |
| AWD4820 | | 20.0 | | | | | 14.0-16.0 |
| AWD4824 | | 25.0 | | | | | 18.0-21.0 |

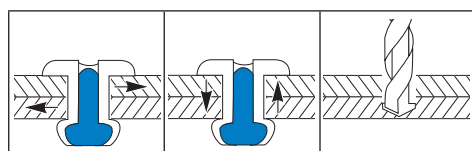

| D ₁ (mm) | (N) | (N) | Ø (mm) |
|---------------------|-------|-------|--------|
| 3.2 | 760 | 980 | 3.3 |
| 4.0 | 1 080 | 1 580 | 4.1 |
| 4.8 | 1 580 | 2 230 | 4.9 |

UNIT PLANT CERTIFICATES



ISO 9001:2000
TS 16949

Scell-it®
Engineering & Development

© 2009 Blue future Intellectual Properties

Data shown are subject to change without prior notice as a result of continuous product development and improvement policy.
Your local Scell-it representative is at your disposal should you need to confirm latest information.